

MICHIGAN STATE
UNIVERSITY

February 11, 2022

MEMORANDUM

To: Committee on Budget and Finance

From: Daniel Bollman *Daniel J. Bollman*
Vice President for Strategic Infrastructure Planning and Facilities

Subject: Purchase of Parker Property in Lansing Twp., MI

RECOMMENDATION

The Trustee Committee on Budget and Finance recommends that the Board of Trustees authorize the purchase of property located at 4035 E. Jolly Rd., Lansing, Michigan.



Office of the
Vice President
for Strategic
Infrastructure
Planning and
Facilities

Daniel J. Bollman
Vice President

Michigan State University
IPF Building
1147 Chestnut Road
Room 101
East Lansing, MI 48824

517-355-3366
Fax: 517-353-6358

ipf.msu.edu

RESOLUTION

BE IT RESOLVED, that the Board of Trustees of Michigan State University hereby authorizes the Administration to purchase the property located at 4035 E. Jolly Rd. Lansing Twp., in Ingham County, Michigan for \$700,000, and upon such other terms and conditions as may be acceptable to the President or his designee.

BACKGROUND

The property comprises 20 acres, a house and outbuildings. MSU has historically leased 15 of the 20 acres of this property that is used by the College of Agriculture and Natural Resources for crop production. The property is surrounded by MSU property. MSU has been interested in acquiring this property for several years due to its location.

cc: Board of Trustees, S. Stanley, T. Woodruff, N. Beauchamp, M. Woo, M. Zeig, E. Scarsons, L. Frace, M. Zeig, B. Quinn, L. Gremel, K. Wilbur, V. Gore, B. Kranz, M. McCabe, C. Leese, J. Rayis, C. Reid

Purchase of Parker Property in Lansing Township



McLaren
Greater Lansing
New Hospital
Site

Subject
Property on
Jolly Road

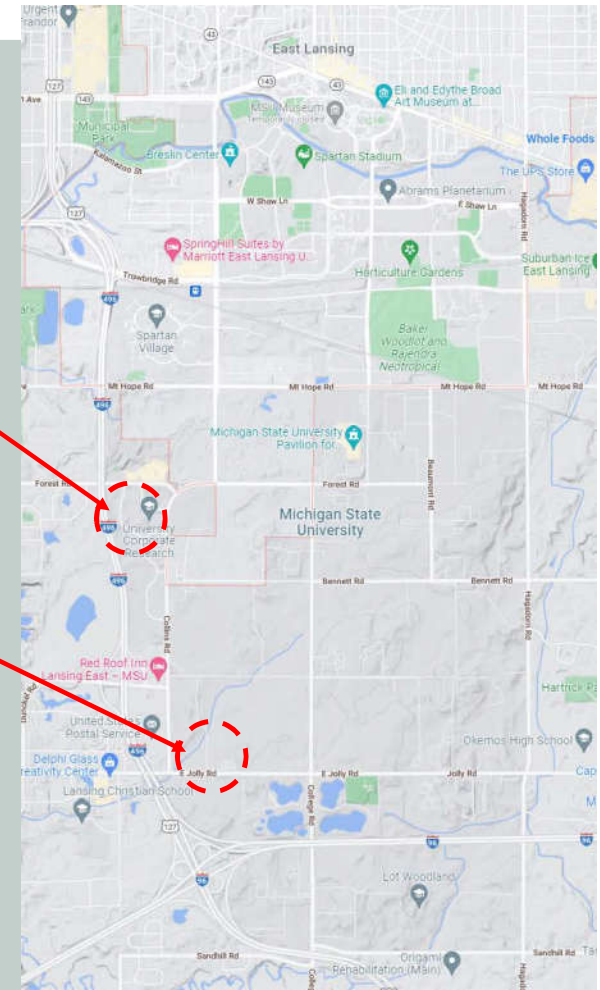

The 20-acre parcel is surrounded by MSU south campus property on the north side of Jolly Road. MSU currently leases 15 acres of the property for the College of Agriculture & Natural Resources.

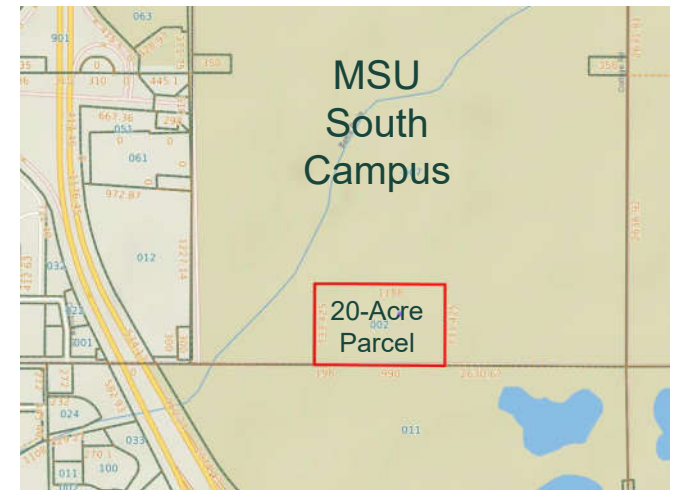

Parker Property